

SunLike MTE Bulb User Manual

SunLike

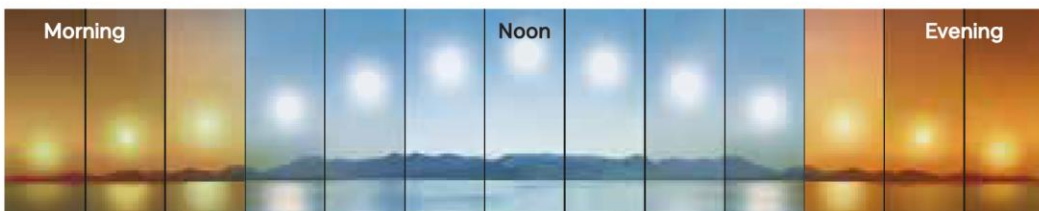

Precautions for use

1. This product is for indoor use only. Do not use outdoors.
2. Make sure the power is turned off before installation or disassembly.
3. To prevent electric shock, do not touch with wet hands.
4. Make sure the product is firmly inserted into the socket or holder.
5. Use only within the rated voltage.
6. Do not use with direct current (DC) power or dimming devices.
7. Do not touch the product while it is on or immediately after it is turned off as it is hot.
8. Do not disassemble or modify the product arbitrarily.
9. Do not insert any foreign substances into the product.
10. Do not use in humid environments, sealed lighting fixtures, or places where water may enter.

Names of each part and product specifications

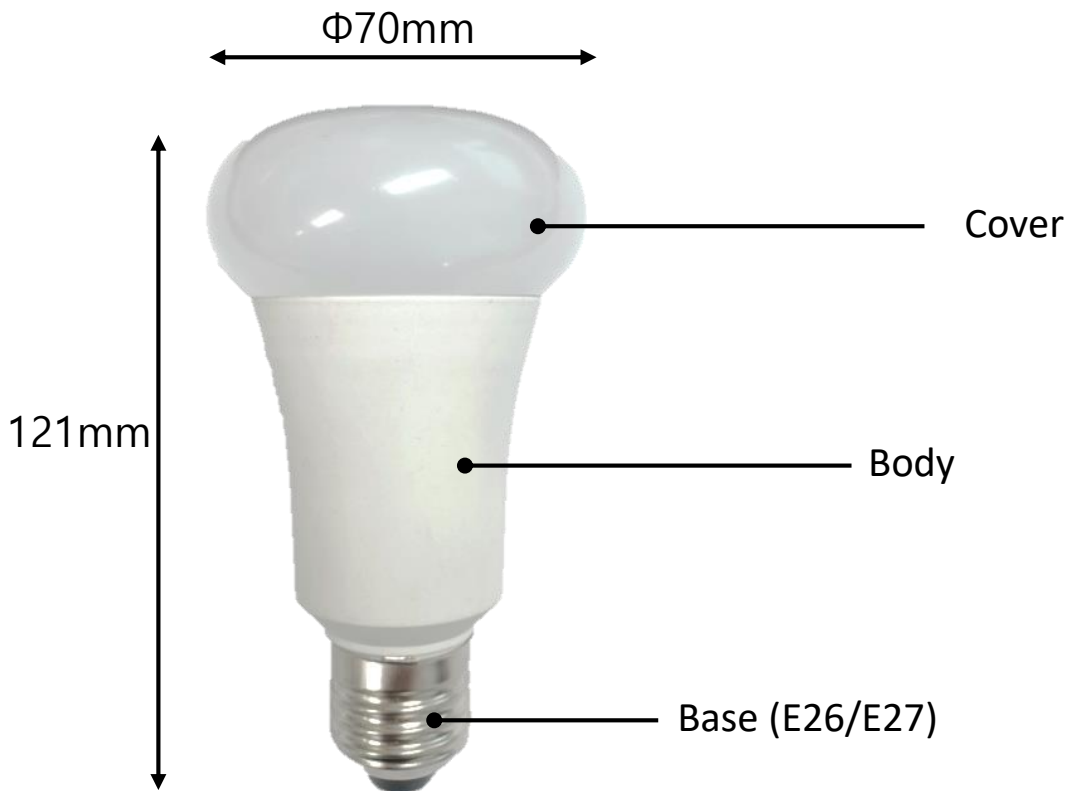

Name of the device	SunLike MTE Bulb
Input voltage	AC 110V ~ AC 220V
Frequency	50Hz ~ 60Hz
Power consumption	8W
Product Size	$\Phi 70\text{mm}$ X H 121mm
Base type	E26 / E27

App User Manual

◆ Before using the product

1. Install the app Search for “SunLike” in the App Store or download the app from the QR Code on the left.
2. Run the app Run the installed app and allow the “Location” permission.
3. Make sure there is a Wi-Fi environment where the product is installed. If there is no Wi-Fi environment, MTE may not work properly.

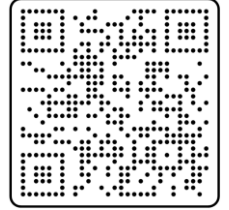

◆ App screen description

1. Main screen

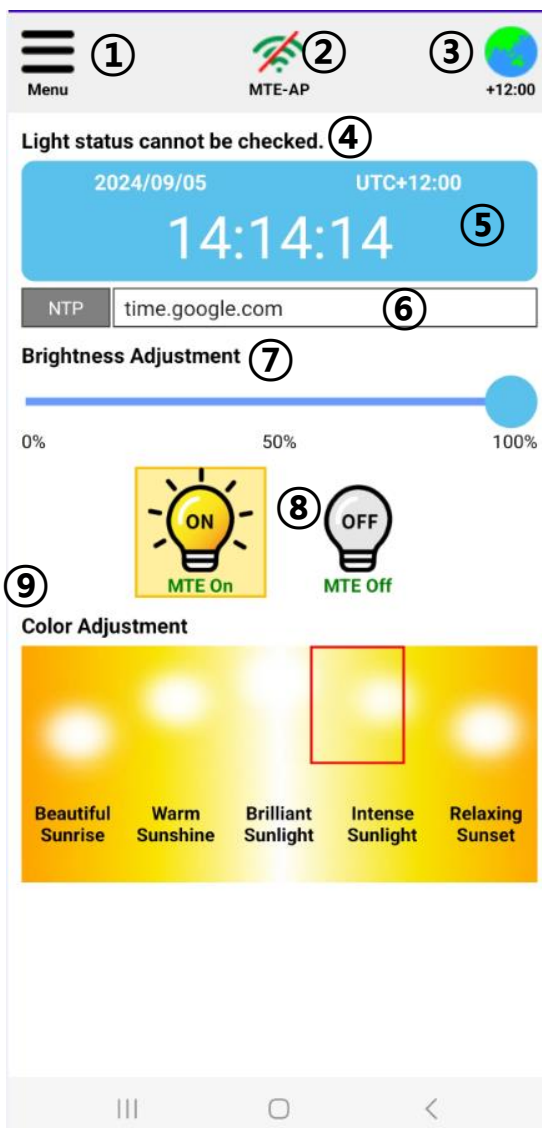

① Setting details menu

② Product Wi-Fi connection status display

③ UTC setting

④ Lighting status display

⑤ Current time display according to UTC setting

⑥ NTP server setting

⑦ Product brightness adjustment

⑧ MTE and product On/Off setting

⑨ Product color adjustment

App User Manual

2. Main screen details

① Setting details menu

Enter the menu to search and set up the product.

The details of the menu are explained separately

② Product Wi-Fi connection status display

Displays the status of the product's Wi-Fi connection.



: Not connected



: Connected

③ UTC setting

You can set it to the desired time zone. (Korea: +09:00)

④ Lighting status display

When the product is connected, the product's unique ID is displayed.

⑤ Current time display according to UTC setting

Displays the current time according to UTC setting

⑥ NTP server setting

Sets the NTP server.

⑦ Product brightness adjustment

Adjusts the brightness of the product.

⑧ MTE and product ON/OFF setting

Sets MTE operation ON/OFF.

When OFF, adjust brightness or select a color, it operates in manual mode.

When selecting a color while MTE is operating, it operates in manual mode.

⑨ Product color adjustment

Displays the current product color when MTE is operating. When you select a color, it changes to the selected color and operates in manual mode.

App User Manual

3. Product Connection

- When you press the menu button on the main screen, the following screen will appear.

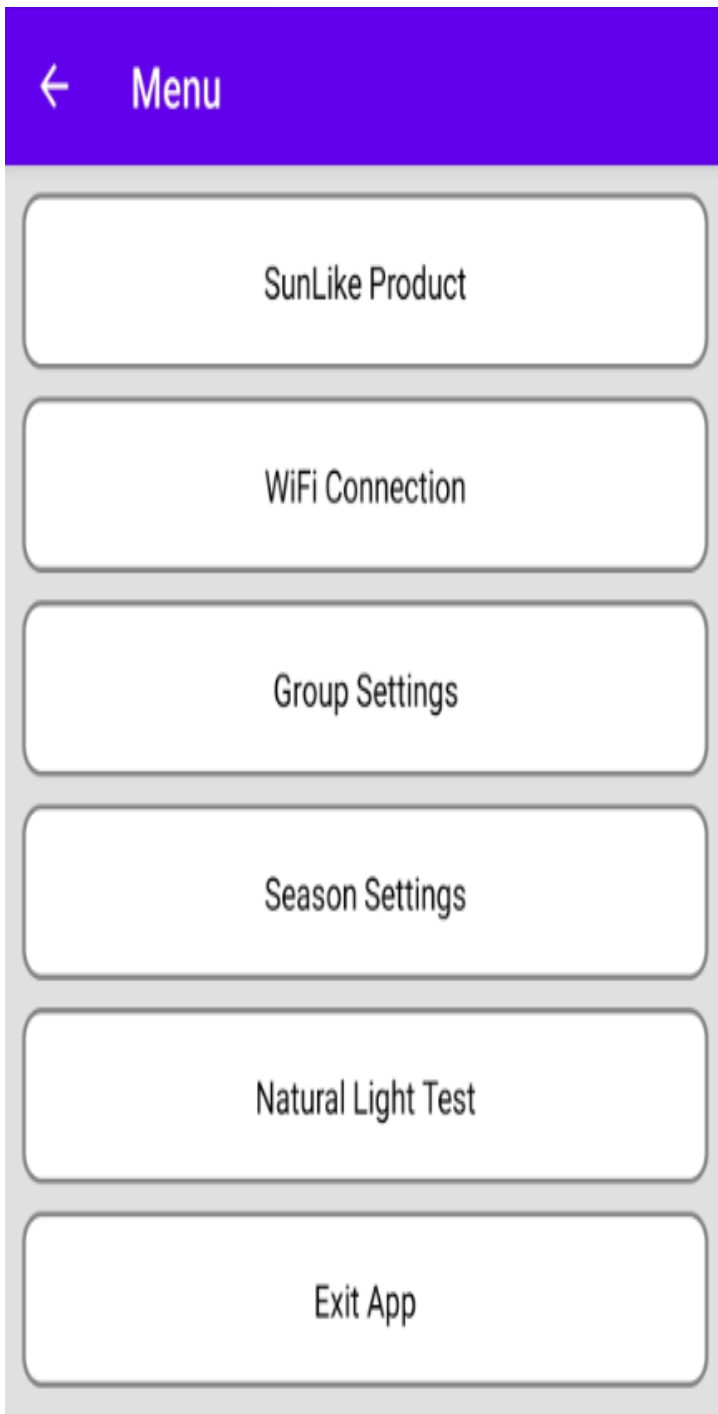

Use when connecting a single product.

Use when connecting a connected product to Wi-Fi.

Use when controlling multiple products as a group at the same time.

Set the season when MTE is operating. → Set the time of sunrise and sunset.

Implement natural light from morning to evening within about 30 seconds.

Exit the app.

App User Manual

- Single Product Connection Setup.

Click the SunLike Products button in the menu.

The screen will appear as shown below.

Click Product Search to search for nearby SunLike MTE products.

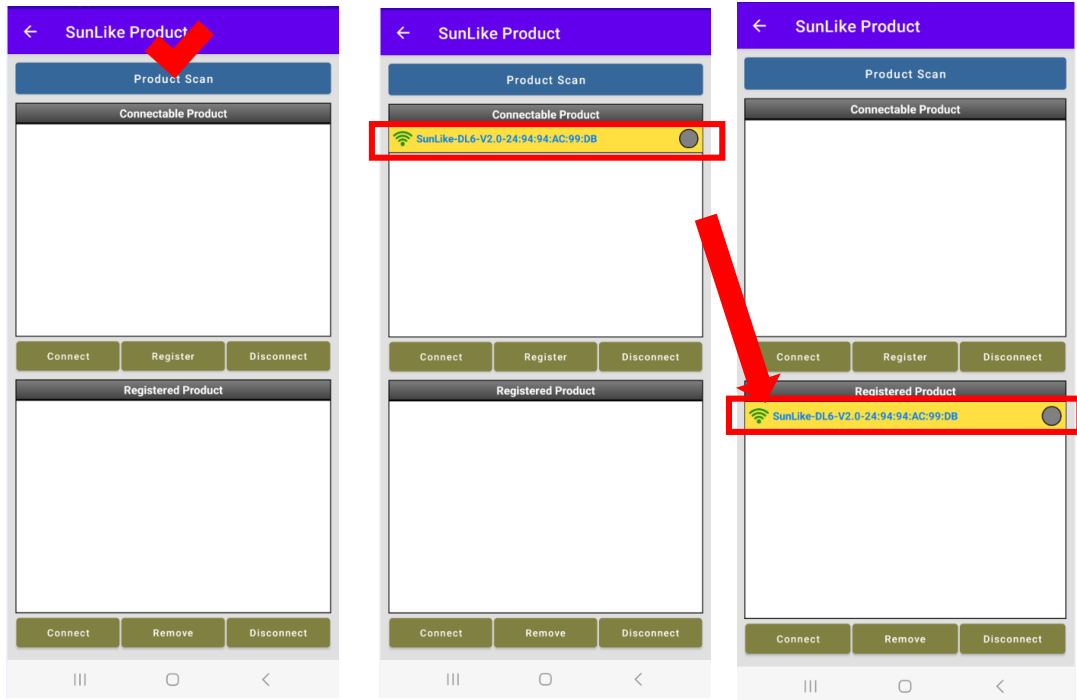

When you click on the desired product among the searched products, the background color will be displayed in yellow. (If there is only one product, it will be displayed in yellow.)

When the yellow display is on and you click the register button, the product will be moved to the registered product.

Caution: You can connect to the searched product, but the searched product will disappear when you close the app, and the registered product will not disappear when you close the app and will remain when you open the app again.

Click on the product you want to connect and click the connect button at the bottom. The product will be connected and the light on the product will blink twice. If the circle to the right of the product ID turns green, it is normally connected.

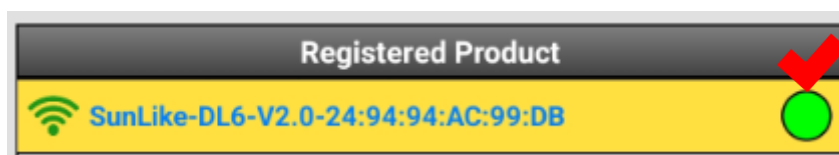

App User Manual

Once connected, you can return to the main screen and operate the product.

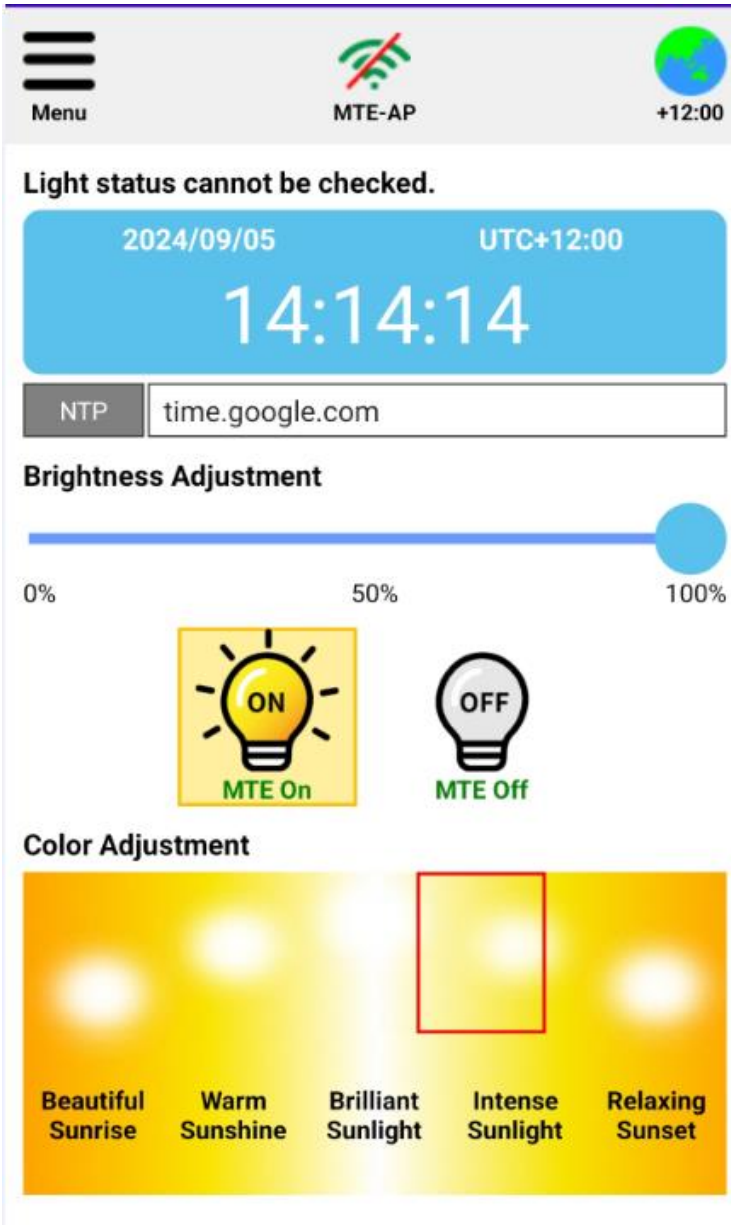

Brightness adjustment

You can adjust the brightness by sliding the slider.

MTE On/Off

You can turn the product on and off by pressing the button.

Color adjustment

If you press the text below the color adjustment, the color of the product will change to the corresponding light.

You can also adjust the color by sliding the red box.

Caution: When you press the OFF button, the product's light will turn off. When you press the ON button again, it will turn on and perform MTE operation. To perform manual operation, adjust the brightness or color in the OFF state. When you do this, it will perform manual operation.

App User Manual

- Wi-Fi connection setup

When you press  button on the main screen, the Wi-Fi search screen will appear.

Note: The button is activated only when the product is connected.

Select the Wi-Fi you want to connect to from the list. (Yellow background when selected)

After selecting, press the Wi-Fi settings button, enter the password for the Wi-Fi, and press OK. After the settings window appears, press the Wi-Fi connection button to connect.

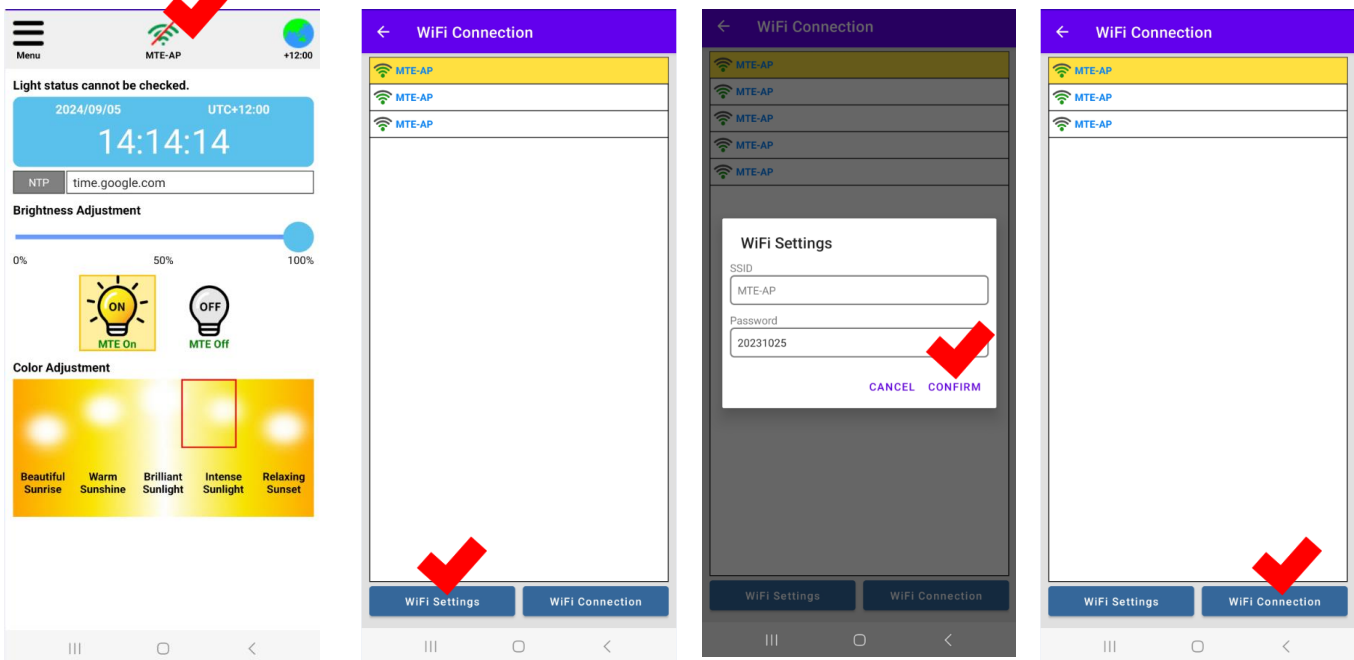

When you press the Wi-Fi button, you will exit to the main screen, and after a while, the Wi-Fi icon will be displayed as connected.



Caution: Depending on the strength of the Wi-Fi signal, it may take up to 2 minutes and if the sensitivity is not good, the connection may be delayed further or may not be connected. If the connection is not made, the ID or password was entered incorrectly.

Re-set the connection settings and enter the password correctly.

You can also set it with the Wi-Fi connection button on the menu screen. However, in this case, you must know the SSID correctly.



App User Manual

- NTP Settings

When you press the NTP address on the main screen, the NTP server settings window will appear. Select the address you prefer or the address that has a good connection. The function is the same as the address that retrieves the time standard, and if the connection is not made, the time will not be displayed correctly.

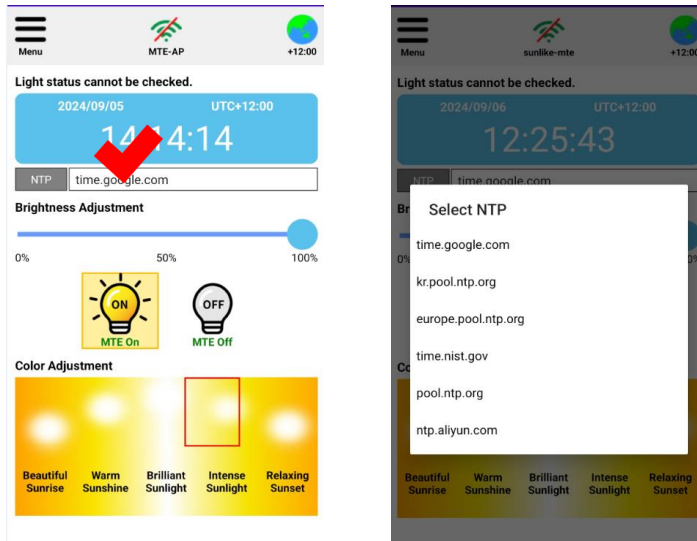

- UTC (Region) Setting

If you press the globe (UTC) button on the main screen, the UTC (Region) setting screen will appear, and you can set the desired region and standard time. Move the red bar on the map to set the hour unit, and set the minute unit with the slide bar at the bottom. (5-minute intervals)

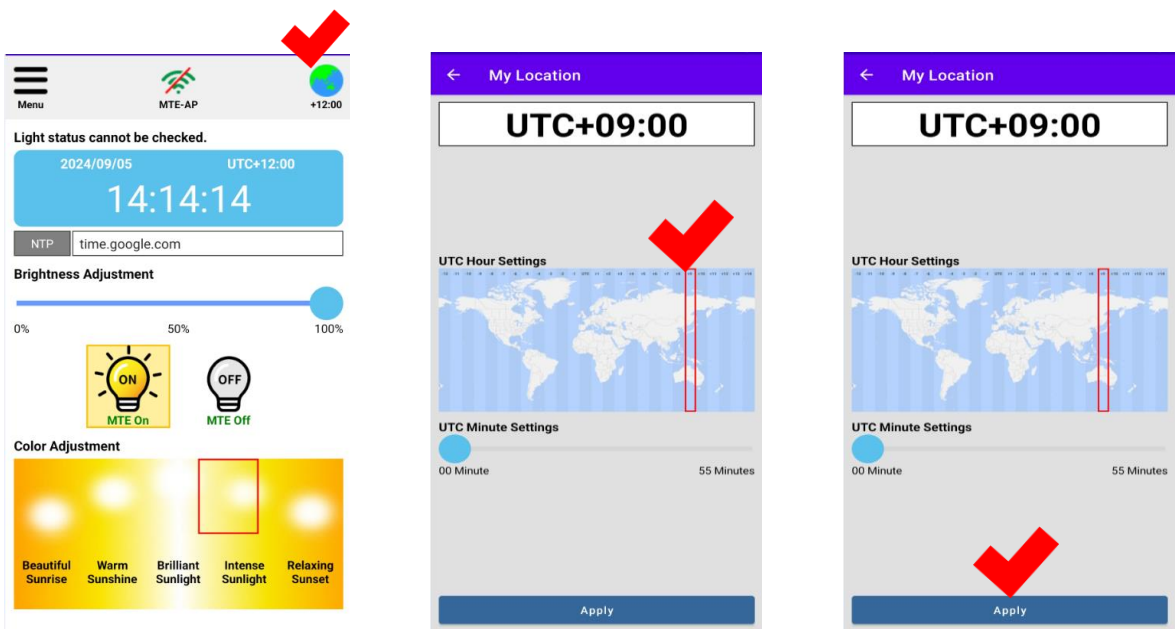

App User Manual

- Season Setting

You can set the sunrise and sunset times through the Season Setting. Click the Season Setting button in the menu. The Spring, Summer, autumn, Winter, and User Setting screens will appear as shown below. Spring ~ Winter have fixed sunrise and sunset times, and you can change them by using User Setting.

Click the time for Sunrise Time and Sunset Time next to User Setting to change the time.



App User Manual

- Group Setting

This product can control multiple products at once through group setting. If you use multiple products in one space, you can use them conveniently by controlling them at once through group registration. Press the Group Setting button on the menu screen.

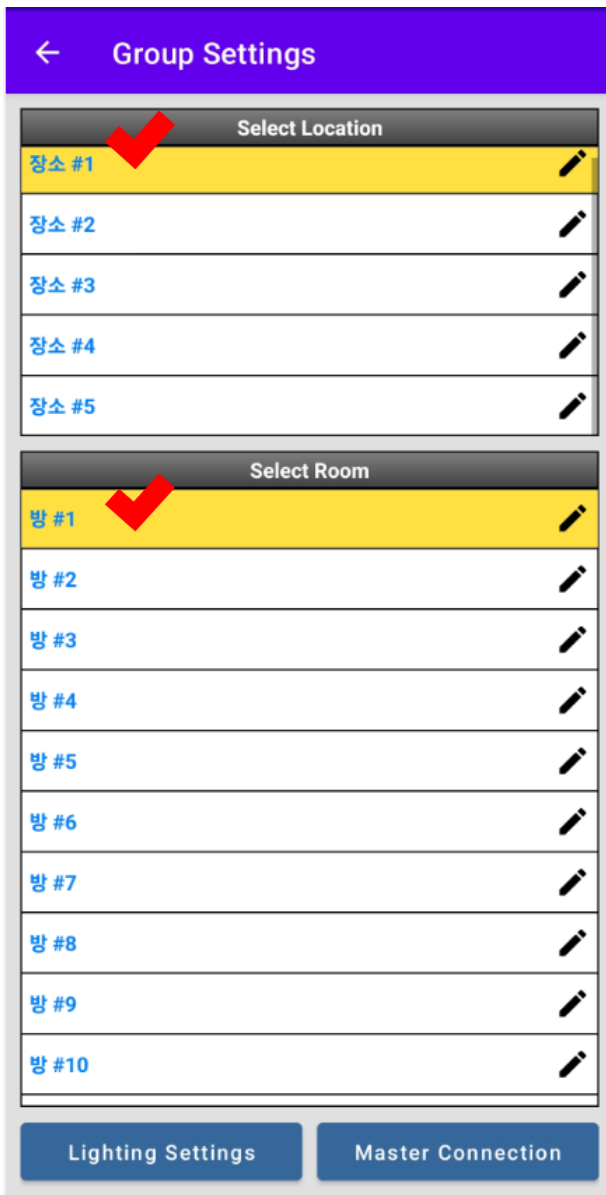

You can set up five locations and 10 rooms per location. When you select a location and room, the selected location and room will be displayed in yellow. Select a location and room, and press the Light Setting button.

- Continue to the next page -

You can change the name by pressing the pencil icon.



After setting up the group, select a location and room, and press the Master Connection button. You can connect the Master connection without entering the Lighting settings.

Caution: If you register a group, products with Slave-light settings can no longer connect to Wi-Fi and will only operate under the control of the Master lighting.

App User Manual

When you press the lighting settings button, the product registration screen appears as shown below..

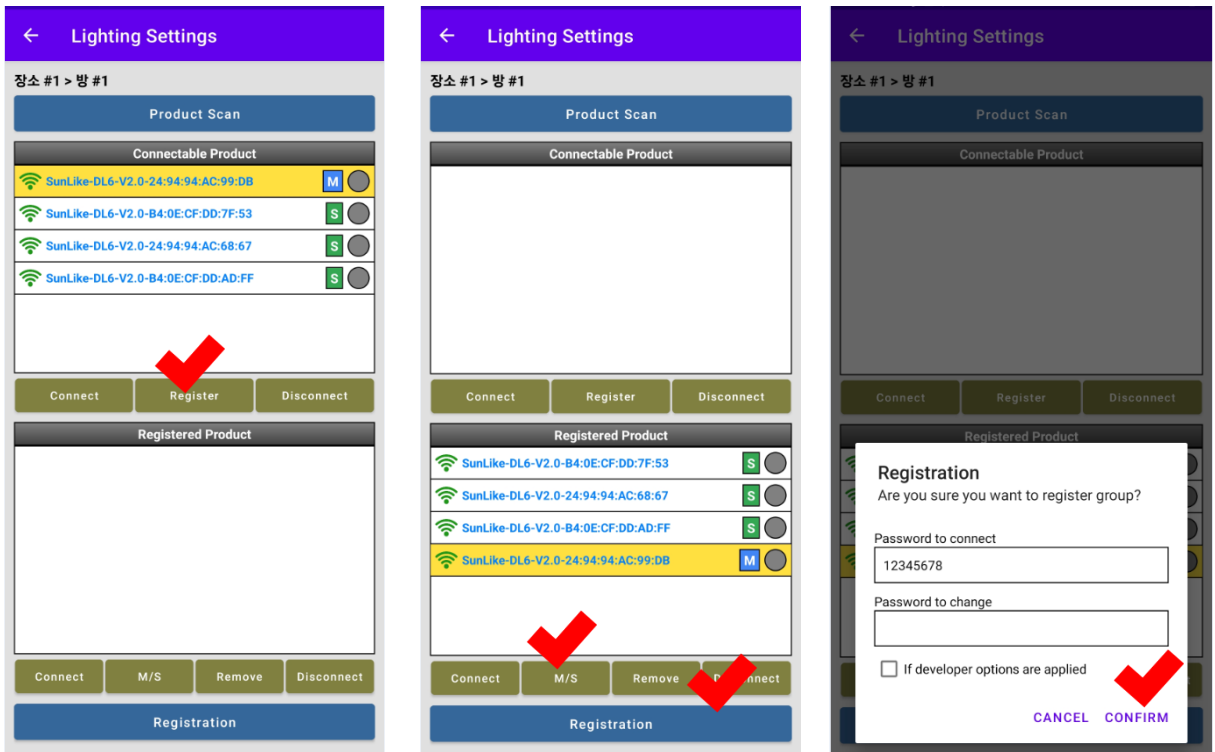

Press the product search button to search all products around you. Here, select a product and press connect to check which product is selected. (It blinks twice when connected.) Press register all products you want to group to move to the registered product screen below. Select the product that you want to use as the Master light among the registered products and press the M/S button. Only the selected product will be the main light and the rest will be automatically set as Slave-light. After selecting the M/S, press the group registration button. The group registration decision screen will appear and you can set the password. If you do not set the password, the default value is "12345678". Once the setting is complete, select the Master light and press the connect button to connect the product. Once connected, you can control and set it in the same way as registering a single product on the main screen. Slave-lights are controlled in the same way as the Master light. Caution: Search is limited by Google Wi-Fi policy, so it takes 30 seconds per product when registering. Please wait without doing any other actions until the setting is complete. Please note that if you forget your password, you will not be able to log in.

App User Manual

- Natural Light Test

This product can check the natural light from sunrise to sunset. With this function, you can feel the change of light from sunrise to sunset. Press the Natural Light Test button on the menu screen.



The test screen appears as shown below, and when you press Start, the product's lights will turn off and the light from sunrise to sunset will be shown for about 30 seconds. The test will end about 30 seconds after the test starts, and when it ends, it will return to the color and brightness just before the test started. If you want to stop the test, press the End button.

Caution: The main screen will not operate during the test, and will operate after it ends. It will end automatically or you must press it to end. In the case of a group, only the Master lighting will be tested, and the Slave-light will not be tested.

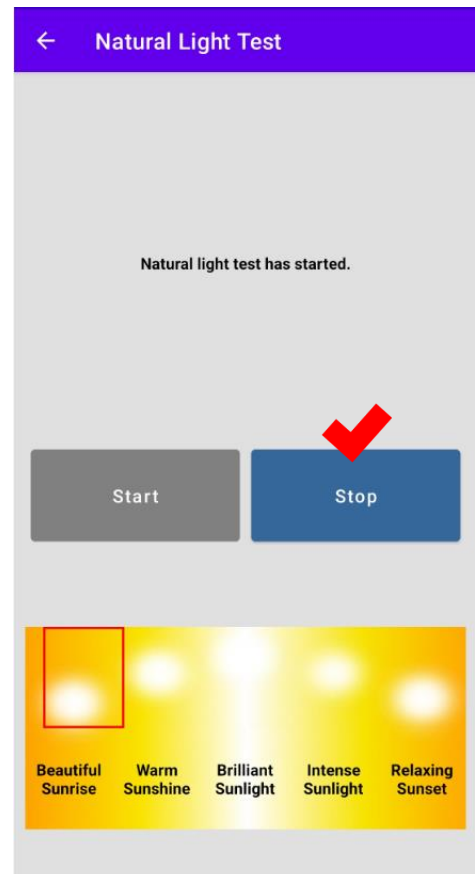

App User Manual

- Factory Reset

When the product is connected in the app, the Restart button and Factory Reset button at the bottom are activated.

Restart: Restart only the product while leaving the settings as they are

Initialize: Reset all settings and restart.

Please note that all settings will be reset when factory reset is performed In the case of group settings, the Ungroup button will ungroup the group and factory reset it.

At this time, all of the auxiliary lighting products will also be factory reset, and Wi-Fi search will be

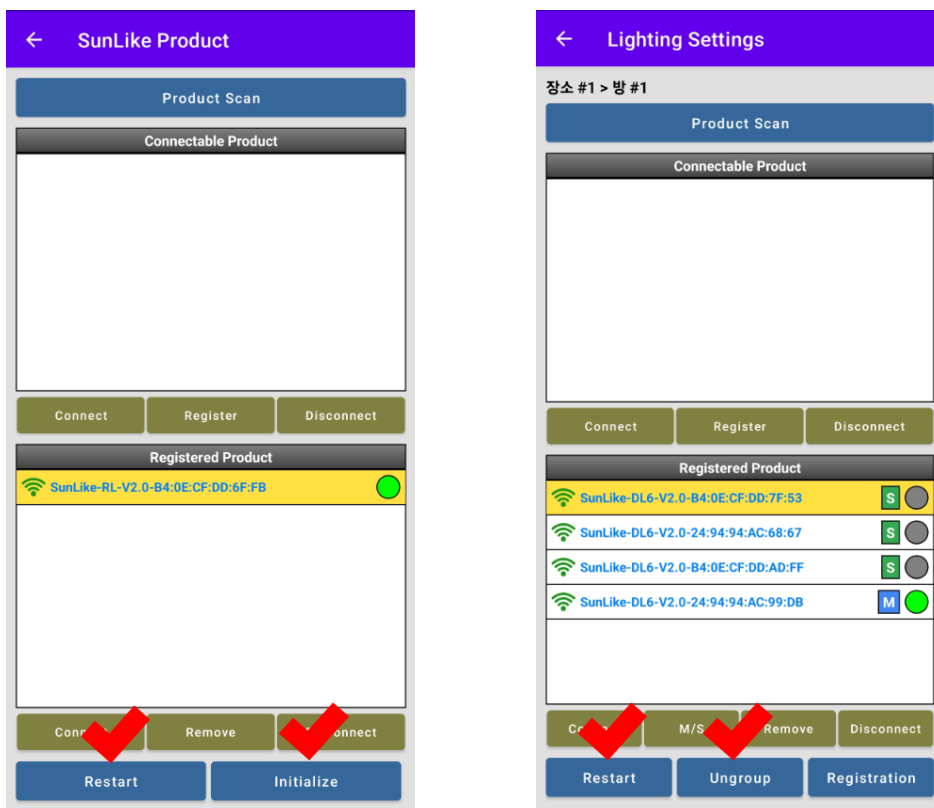

If you have forgotten your password or do not have a device registered with the app, You can reset it with the power button connected to the product.

How to reset the power button to factory settings:

Turn the power OFF and then ON.

When you turn it ON, turn the power ON/OFF 3 times within 3 seconds. Factory settings will be reset.

Product Certificate

Name of the device

SunLike MTE Bulb

Manufacturer /
Country of
manufacture

Dixon Technologies (INDIA) Limited / India

Importer

Seoul Semiconductor Co., Ltd.

Seller

Model name

KC Certification

Date of
manufacture

SunLike MTE